

1. Safety Rules: The use and installation of the MaxCell MaxBag does not require taking any special safety measures other than the ones implied in the process of installation and removal.
2. Tools: No specific tools or equipment needed for its installation.
3. Packaging Contents: The MaxBag solution consists of the bag with an internally housed capsule of compressed gas. Upon pulling the cord, the gas is released automatically inflating the product. No tools are required for its installation.

## Installation Instructions

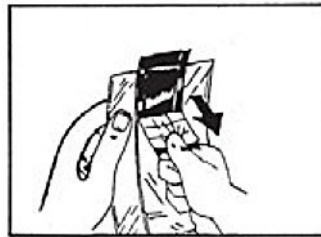

**Step 1:** Clean the duct and the cable jacket.



**Step 2:** Remove the protective paper of the inner sealing tape that will be in contact with the cables while unrolling the product.

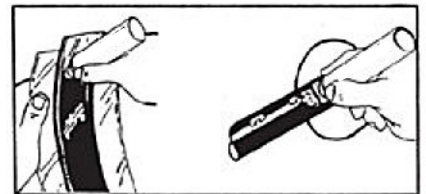

**Step 3:** Lubricate abundantly the part of the cable jacket which is in contact with the MaxBag and the interior and exterior mastic sealing on bag.

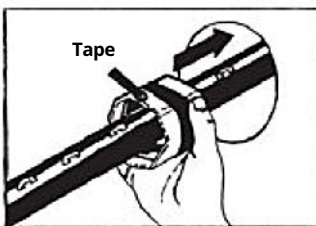

**Step 4:** Wrap the MaxBag around the cable, according to the way it was packaged, making sure the mastic seal makes contact where the bag overlaps itself. Make certain the side with the pull cord is facing out from the duct. At this point, the MaxCell fabric duct may be pushed into the duct behind the bag or pulled through the bag and left exposed. Remember to tie the pull tape through each cell and leave exposed slack for future use.

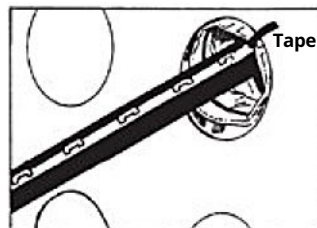

**Step 5:** Move the MaxBag into the duct making sure the body of the MaxBag maintains its cylindrical shape and the outer side of the bag is completely within the duct opening. Adjust the sealing bag to the inner shape of the tube. In the case of two or more cables occupying the conduit, wrap the bag around all cables. Do not allow the bag to create a separation between the cables.

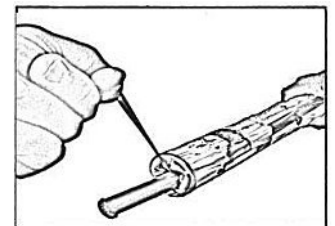

**Step 6:** Take the cord in hand. Before pulling it, verify the position and then pull the cord towards the outside of the tube and perpendicular to the cable<sup>1</sup>. Pulling it triggers the gas capsule automatically inflating the bag and completing installation of the product.

<sup>1</sup> Do not pull the cord in the direction of the cable, nor towards the center of the duct, as the interior gas capsule cannot be activated this way. Improper handling of the cord can cause it to weaken or even come loose. Should the cord detach, you can activate the device manually by applying pressure to the leftover glue where the cord was located. This can be done by hand or by applying pressure with the cable itself. **Installation is now complete.**



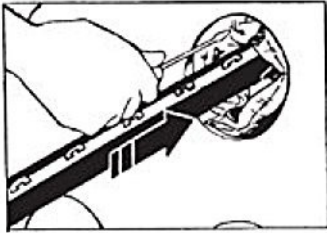

**Step 1:** Simply deflate the bag by piercing it with a screwdriver or other rigid edged tool. Make sure you do not damage the cable.



**Step 2:** Separate the cable, the bag and the tube.

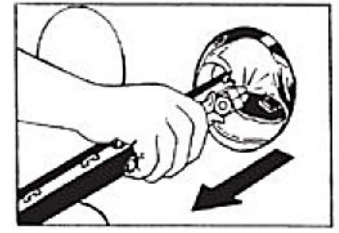

**Step 3:** Remove the bag using the pullcord or pliers.

**MaxBag is now completely removed.**

For more information on MaxCell, go to [www.maxcell.us](http://www.maxcell.us).  
Watch MaxCell and MaxSpace videos on our YouTube channel at [www.youtube.com/MaxCellInnerduct](http://www.youtube.com/MaxCellInnerduct).



## MAXLUBE

Utilization of proper cable pulling lubricants are essential in obtaining optimum results. Consult your MaxCell representative for cable pulling lubricant recommendations. MaxLube was specifically designed to improve MaxCell's performance under the most challenging applications.

### MaxLube Simplifies Your Installation Process

MaxCell used with MaxLube provides the fastest pull possible, reducing installation times significantly. It meets our customers' needs for an easy to use, effective cable lubricant.

- Perfect for OSP, drop and data cables
- Easy application with pre-saturated wipe, re-saturate wipe with spray bottle as needed
- Lubricates with very thin film, performs just as well after drying
- Non-staining, quick clean-up
- Compatible with common cable jackets including polyethylene

**MaxLube is a convenient lubricant for pulling fiber optic cables with wipe-and-spray application. Because it's concentrated, only a thin film is required for immediate tension reduction that lasts. Just spray or wipe the cable as it enters the MaxCell sleeve. It's quick and easy to use without mess or excess lubricant.**

